

SIDE VIEW

FRONT VIEW (Partial)

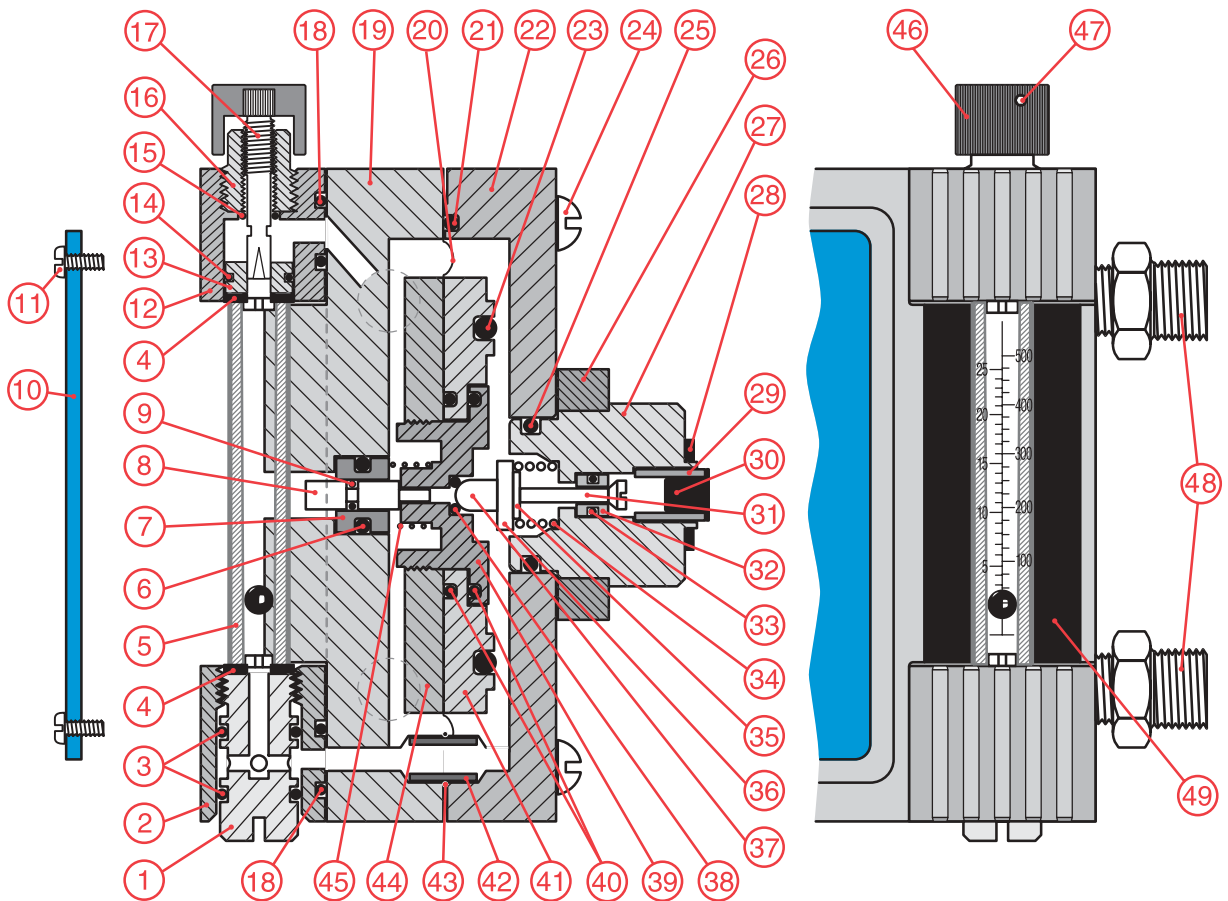

Item No.	Description	Quantity	Part No.	Item No.	Description	Quantity	Part No.
1	Inlet Plug	1	FM-101A	30	Teflon Filter	1	T-210
2	Bottom Meter Block	1	FM-103	31	Inlet Valve	1	YM-100A
3	O-Rings	2	3PS-112	32	Inlet Valve Seat	1	YP-101A
4	Meter Gaskets	2	MG-001	33	O-Ring	1	3RS-010
5	Flow Meter	1	MT-B-11	34	Inlet Spring	1	YM-103
6	O-Ring	1	3RS-014	35	Bearing Washer	1	YM-101A
7	Pin Guide	1	FB-104	36	Spring Retainer	1	YP-100
8	Guide Pin	1	DM-101A	37	Vent Plug	1	YM-102A
9	O-Ring	1	3RS-006	38	O-Ring	1	3RS-009
10	Cover Plate	1	FB-105	39	Diaphragm Vent Bolt	1	DP-102A
11	Cover Plate Screws (Nylon)	2	#6-32 x 5/16"	40	O-Rings	2	3PS-029
12	Top Meter Block	1	FM-100B	41	Rear Diaphragm Plate	1	DP-101A
13	Rate Valve Seat	1	VT-104	42	Tube Connector	1	FB-106
14	O-Ring	1	3RS-012	43	O-Ring	1	3RS-012
15	O-Ring	1	3PS-106	44	Front Diaphragm Plate	1	DP-100A
16	Valve Bonnet	1	VB-100C	45	Vent Spring	1	DM-100
17	Rate Valve	1	VP-103C	46	Rate Valve Knob	1	RV-100A
18	O-Rings	2	3PS-110	47	Rate Valve Knob Set Screw	1	#5-40 x 1/4"
19	Front Body	1	FB-100A	48	3/8" Vent & Vacuum Fitting	2	F-104
20	Double Diaphragm	1	DP-103	49	Meter Shield	1	
21	O-Ring	1	3PS-156	*	Meter Block Screws (Monel)	4	#10-24 x 1"
22	Back Body	1	BB-100A	*	Yoke Screws (Monel)	2	1/4-20 x 1 7/8"
23	O-Ring	1	3PS-332				
24	Body Screws (Monel)	4	1/4-20 x 1 1/2"				
25	O-Ring	1	3PS-214				
26	Back Plate	1	YM-105A				
27	Seal Adapter	1	SAWS				
28	Lead Gasket	1	LG-100				
29	Filter Holder	1	KFH-200				

hydro
INSTRUMENTS...
VACUUM REGULATOR

Date: December 2002
Scale: 67%
Dwg. No. Series 500★